



A TRANSPORTATION MANAGEMENT ASSOCIATION

tmabucks.com

Private, 501 (c) 4 Non-Profit Organization

Membership Supported:
Thanks to our current members!
Join online today: tmabucks.com

Our Mission:

Providing leadership & advocacy for
transportation management services and
solutions that impact Bucks County

- ❑ Improved Transit
- ❑ Less Congestion
- ❑ Less Vehicle Pollution
- ❑ Improved Access to Jobs
- ❑ Safer and More Appealing Facilities



- ❑ Traffic Counts/Observations
- ❑ Road Safety Audits
- ❑ Passenger Shelter Programs
- ❑ Multi-Municipal Coordination
- ❑ Task Forces/Working Groups
- ❑ Alternative Fuel Projects
- ❑ Education Programs/Events



Level 1

120V

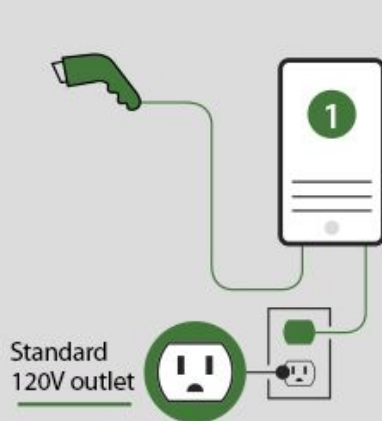



Adds 5 miles
per hour
of charge*

Residential use

Level 2

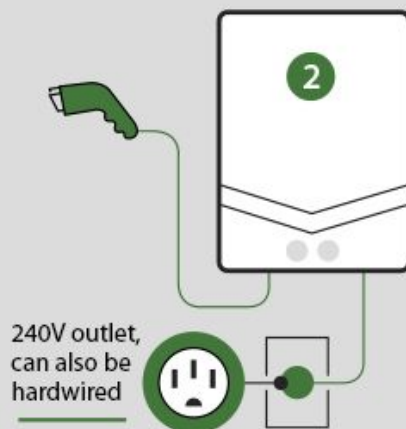
240V





Adds 20-60
miles per hour
of charge*

 
Residential &
commercial
use

Level 3

480V

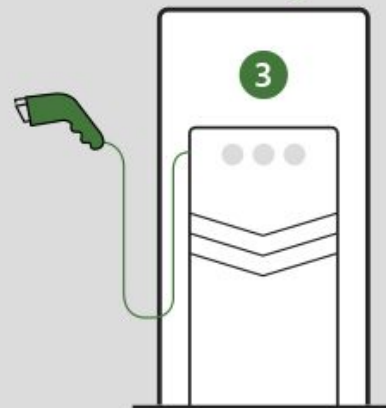
DC Fast Charger



Adds 60-100 miles
per 20 minutes
of charge*

Commercial use

** Estimated. Actual charge times may vary.*

“Driving PA
Forward Grant”

(Google it!!)



Your Options:

<u>Project Type</u>	<u>Maximum Rebate per Plug</u>	<u>Maximum % of Total Project Cost</u>
Full Public Access, Networked, Government Owned Property	\$4,000	80%
Full Public Access, Networked, Non-Government Owned Property	\$4,000	70%
Multi-Unit Dwelling	\$3,500	50%
All Other Eligible Projects	\$3,000	50%

Per PLUG, not STATION!!!



EV Charging:
The hard way.



Step 1:

- Identify the location(s)
 - STREET address!
- Each address = one project
- Maximum \$100,000 at a time



Step 2:

- Number Crunching
- Solicit Quotations
- Determine and itemize costs
 - Contractor or In-house



Step 3:

- Apply for your rebate using Keystone Login
 - Location
 - Budget
 - Rebate Calculation Sheet
- **DON'T SUBMIT UNTIL READY TO PROCEED WITH PROJECT!**



Step 4:

- Receive your rebate voucher(s)
- You have 180 days (literally)



Step 5:

- Install and activate station
- Submit final documentation
 - Includes PHOTOS
- Submit payment request



Step 6:

BE PATIENT



Step 7:

- Promotion
- Data Collection
- Three years of reporting





EV Charging:
The EASY way!



Step 1:

- Call  **TMA BUCKS**
A TRANSPORTATION MANAGEMENT ASSOCIATION
- Visit www.tmabucks.com
 - Search “Electric Vehicle”
 - Enjoy the many resources!





Steve Noll
steve@bctma.com
215-244-9082 x 18

tmabucks.com
@tmabucks on twitter
facebook.com/tmabucks
@tma_bucks on instagram